

Connecting Hik-connect with your NVR

1. Download the **Hik-connect** APP.

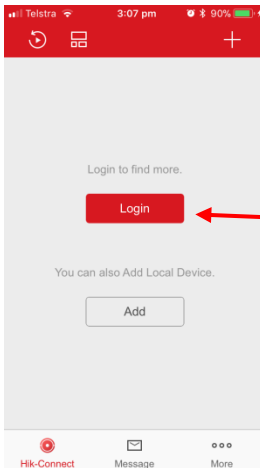

2. Open the app and click **login**.



3. You must **register** first to create a username and password. Once you have registered, log in on the app.

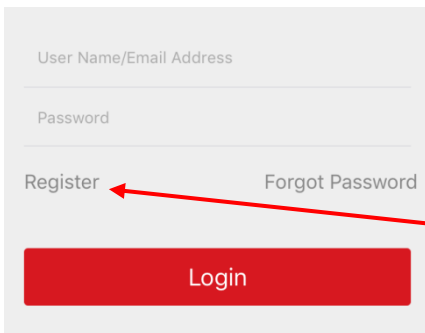

4. Go to the NVR, right click and select **Menu > Configuration > Network**. Tick **Enable DHCP** and click **Apply**.

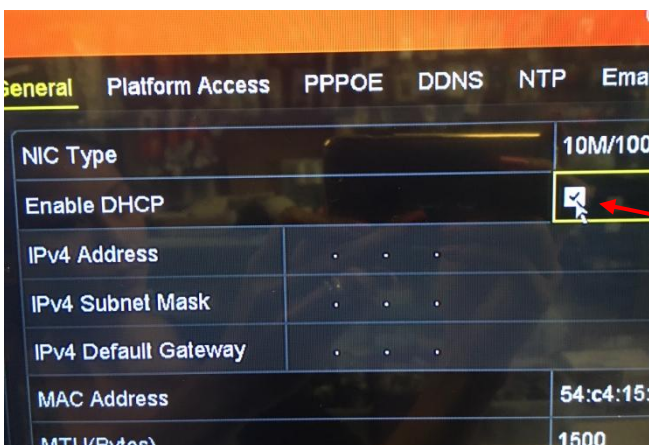

5. Select **Platform Access**. Tick **Enable**.

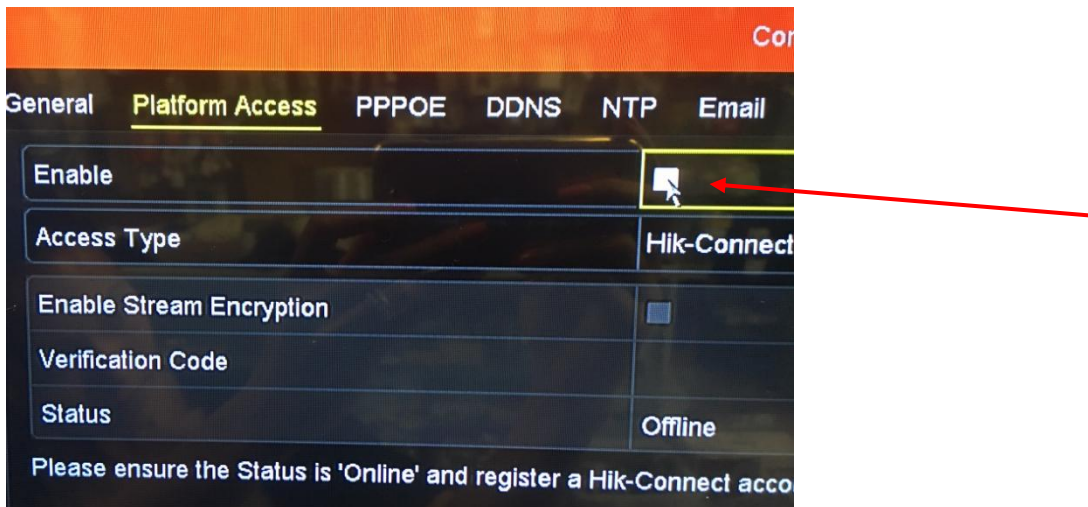

6. Create your own **verification code**. Eg. john1234
Tick the box to agree with Hik-connect terms & conditions. Then click **Apply**.

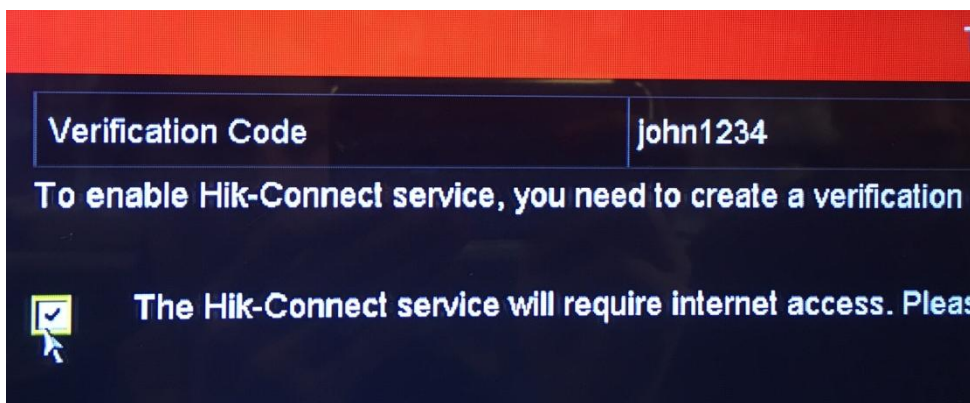

7. Wait until status shows **Online**.

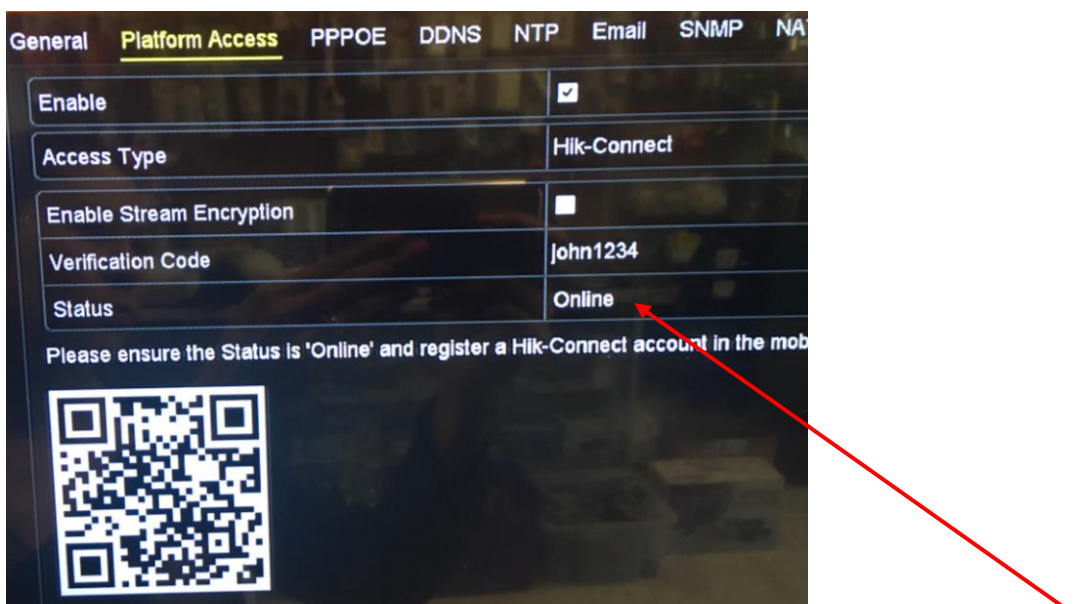

8. Open Hik-connect APP. To add a device tap **+** and then scan **QR Code**. Scan the code showing on your NVR screen. Click **Add**.

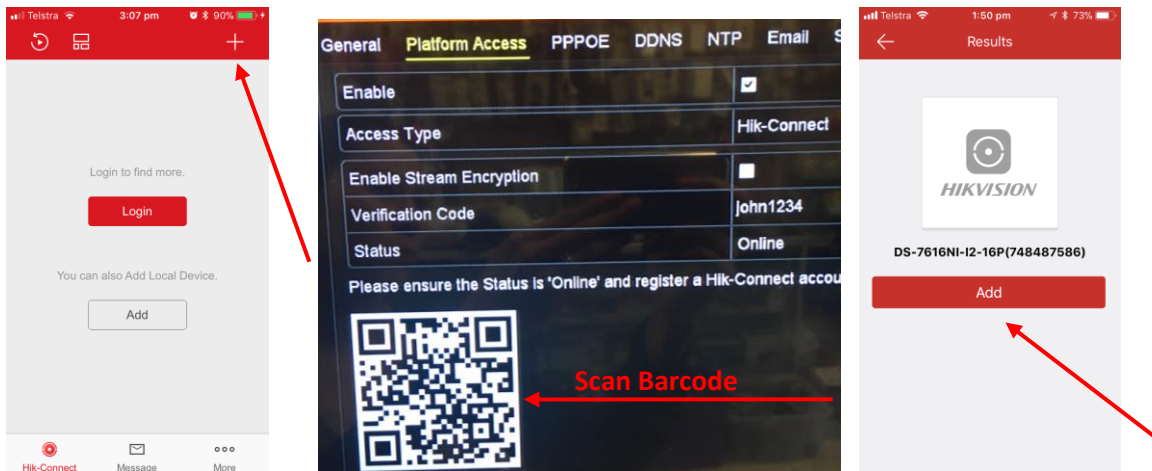

9. Enter your **username** and **password**. Click **Finish**.

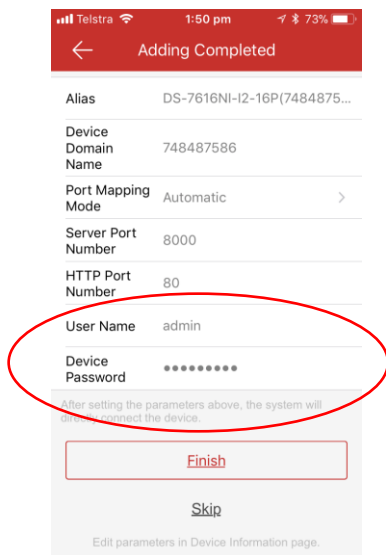

10. Tap on your added device to view your cameras, and double tap to enlarge.

